

Product specification

Customer : _____

Model : _____ SLAUMXNPG20-12 _____

Prepared by : _____ Claudia _____

Checked by : _____

Approved by : _____

Approved by customer : _____

Nominal Voltage		12 V
Capacity (25 °C)	20HR(10.5V)	20 Ah
	10HR(10.5V)	18.2Ah
	1HR(9.60V)	12Ah
Dimension	Length	181 ± 2mm (7.13inch)
	Width	77 ± 1mm (3.03inch)
	Height	167 ± 2mm (6.57inch)
	Total Height	167 ± 2mm (6.57inch)
Approx. Weight		5.8kg (12.784lbs) ± 4%
Terminal type		T3/T8
Internal resistance (Fully charged, 25 °C)		Approx. 12mΩ
Capacity affected by temperature (20HR)	40°C	102%
	25°C	100%
	0°C	85%
	-15°C	65%
Self-discharge (25 °C)	3 month	Remaining Capacity: 91%
	6 month	Remaining Capacity: 82%
	12 month	Remaining Capacity: 65%
Nominal operating temperature		25 °C ± 3 °C (77 °F ± 5 °F)
Operating temperature range	Discharge	-15 °C ~ 50 °C (5 °F ~ 122 °F)
	Charge	-10 °C ~ 50 °C (14 °F ~ 122 °F)
	Storage	-20 °C ~ 50 °C (-4 °F ~ 122 °F)
Float charging voltage(25°C)		13.60 to 13.80V Temperature compensation: -18mV/°C
Cyclic charging voltage(25°C)		14.50 to 14.90V Temperature compensation: -30mV/°C
Maximum charging current		6A
Terminal material		Copper
Maximum discharge current		300A(5 sec.)
Designed floating life(20°C)		10~12 years

- ◆ Absorbent glass mat technology;
- ◆ Recognized by UL & CE;
- ◆ ABS container.

Constant Current Discharge Characteristics (A, 25 °C)

F.V/TIME	10min	15min	30min	60min	2h	3h	4h	5h	8h	10h	20h
9.60V	41.0	34.0	20.0	12.0	6.90	4.90	3.98	3.2 6	2.18	1.85	1.02
9.90V	39.8	33.2	19.6	11.8	6.86	4.87	3.95	3.24	2.17	1.84	1.01
10.2V	38.1	32.0	19.0	11.5	6.80	4.83	3.93	3.2 2	2.15	1.83	1.01
10.5V	36.5	30.9	18.5	11.3	6.70	4.80	3.90	3.2 0	2.14	1.82	1.00
10.8V	34.4	29.2	17.9	10.9	6.53	4.66	3.78	3.10	2.08	1.78	0.98

Constant Power Discharge Characteristics (Watt, 25 °C)

F.V/TIME	10min	15min	30min	60min	2h	3h	4h	5h	8h	10h	20h
9.60V	462	388	229	139	81	58.2	47.4	39.0	26. 2	22.2	12.2
9.90V	449	378	225	137	80	57.8	47.1	38.7	26. 0	22.1	12.1
10.2V	430	364	218	133	80	57.4	46.8	38.5	25. 9	22.0	12.1
10.5V	412	352	212	131	78	57.0	46.4	38.2	25. 7	21.8	12.0
10.8V	388	333	205	127	76	55.3	45.1	37.1	24. 9	21.4	11.8

Note: The above characteristics data can be obtained within three charge/discharge cycles.

Dimensions

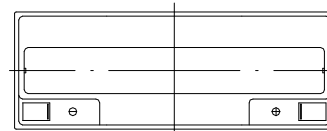
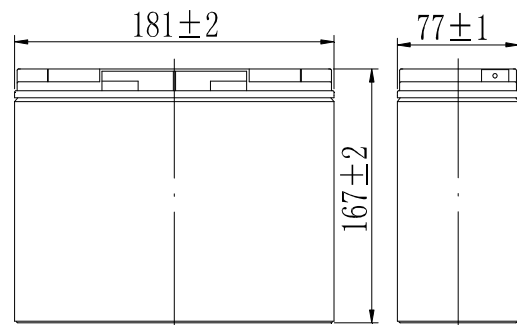

Terminal

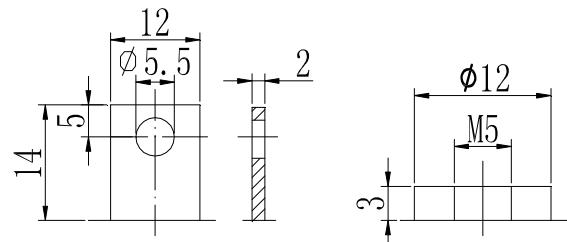

Terminal T3

Terminal T8

Discharge Characteristics(25 °C)

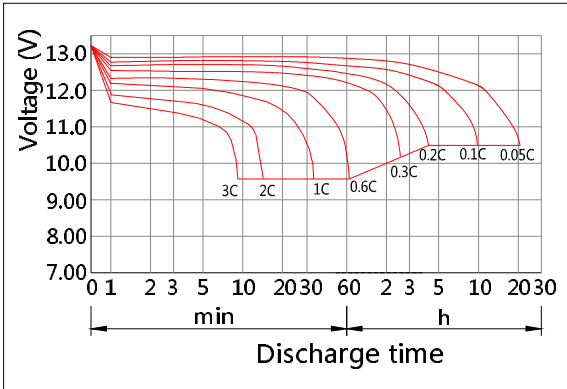

Charging Characteristics(25 °C)

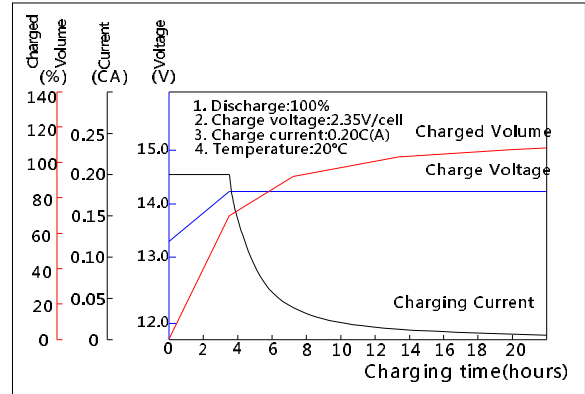

Effect of Temperature on Capacity

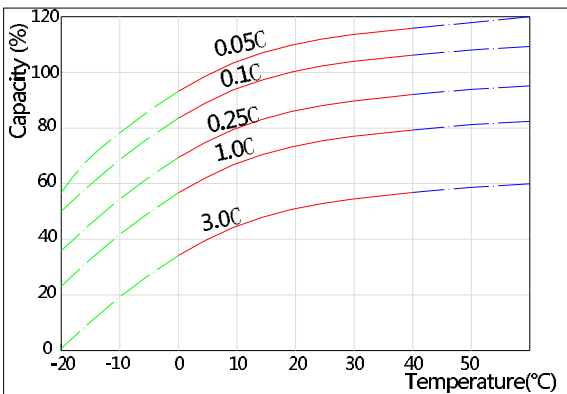

Self-discharge Characteristics

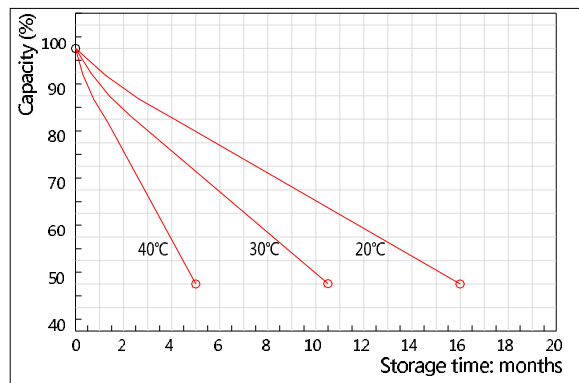

The Relationship for Open Circuit Voltage and Residual Capacity (25 °C)

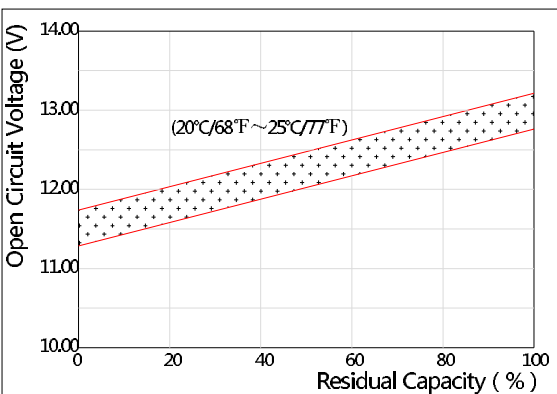

The Relationship for Charging Voltage and Temperature

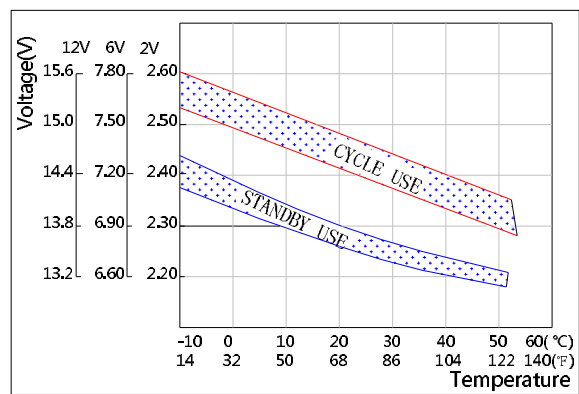

Floating Life on Temperature

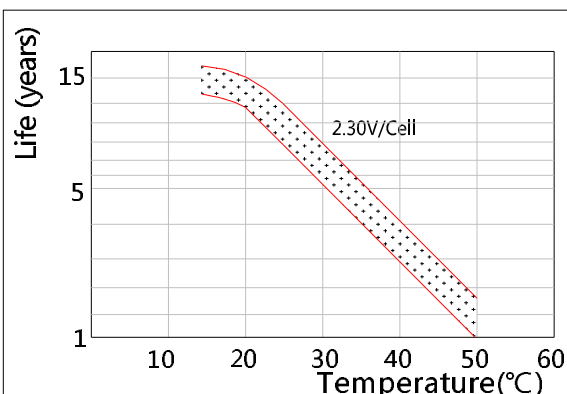

Cycle Life on D.O.D(25 °C)

