

Sealed Gel Rechargeable Battery Product Specification

SLAUMXNPG50-12(12V50AH)



Specifications

Nominal Voltage		12V
Rated capacity (20 hour rate)		50Ah
Dimensions	Total Height	171 mm(6.73 inches)
	Height	171 mm(6.73 inches)
	Length	199 mm(6.83 inches)
	Width	166 mm(6.54 inches)
Weight Approx		14.5 Kg (31.9 lbs)

Characteristics

Capacity 25°C(77°F)	20 hour rate(2.50 A)	50.0 AH
	10 hour rate(4.70 A)	47.0AH
	5 hour rate(8.50 A)	42.5AH
	1 hour rate(27.5 A)	27.5AH
	1.5 hour discharge to 10.5V	20.0A
Internal Resistance	Full charged Battery at 25°C(77°F)	6 mΩ
Capacity affected by Temperature (20 hour rate)	40°C(104°F)	102%
	25°C(77°F)	100%
	0°C(32°F)	85%
	-15°C(5°F)	65%
Self-Discharge at 25°C(77°F)	Capacity after 1 month storage	98%
	Capacity after 3 month storage	94%
	Capacity after 6 month storage	85%
Terminal		T4
Charge (constant Voltage)	Cycle	Maximum Charging Current 15 A Voltage 13.80-14.40V
	Float	Voltage 13.50-13.80V

Outer dimensions (mm)

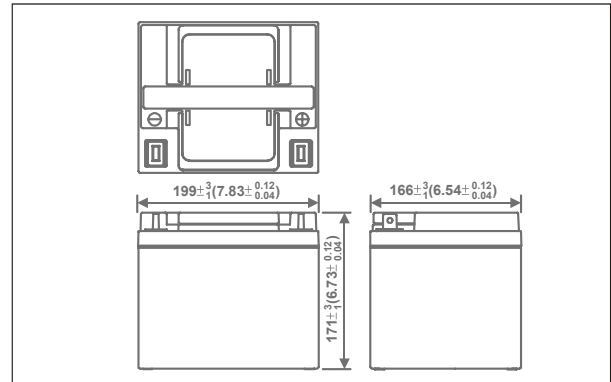

Terminal Type (mm)

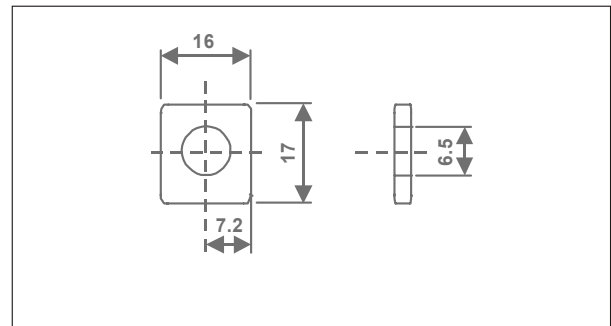

Discharge Curves 25°C(77°F)

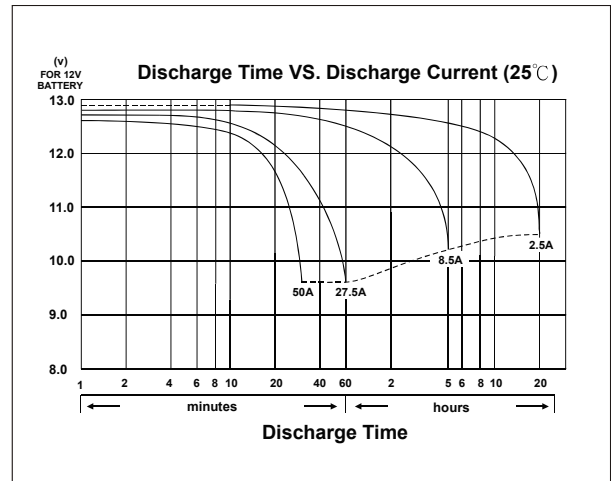

Constant Current(Amp) and Constant Power(Watt) Discharge Table at 25 °C(77 °F)

Time		5 Min	10 Min	15 Min	30 Min	1hr	2Hr	3Hr	4Hr	5Hr	10Hr	20Hr
9.60V	A	193	118	85.5	50.6	29.5	17	12.2	9.88	8.69	4.9	2.61
	W	1950	1326	942	563.4	345	204	147.6	119.4	105	57.42	31.14
10.20V	A	179	110	83	49	28.8	16.4	11.9	9.59	8.5	4.81	2.55
	W	1866	1260	900	541.8	335.4	196.8	142.2	114.6	102	56.28	30.36
10.50V	A	167	103	80.6	47.5	28.1	16	11.6	9.41	8.33	4.75	2.5
	W	1740	1200	864	525	328.2	190.2	137.4	110.4	100.2	55.2	29.7
10.80V	A	149	93.5	77.7	45.6	27.1	15.4	11.2	9.16	8.09	4.64	2.44
	W	1554	1098	786	485.4	318.6	182.4	130.8	106.8	97.2	53.52	28.62
11.10V	A	125	78.1	71.6	40.9	24.4	14.3	10.6	8.67	7.69	4.4	2.32
	W	1296	924	684	421.2	302.4	166.2	120	99.6	93.6	50.64	26.94