

Sealed Lead Acid Rechargeable Battery Product Specification

SLAUMXNP130-12 (12V130AH)

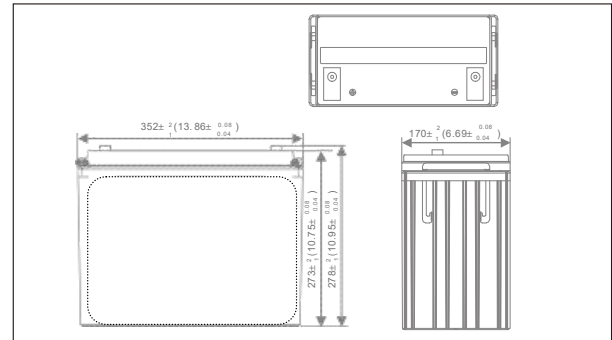

Outer dimensions (mm)



Specifications

Nominal Voltage		12V
Rated capacity (20 hour rate)		130 Ah
Dimensions	Total Height	278mm (10.95inches)
	Height	273mm (10.75inches)
	Length	352 mm(13.86inches)
	Width	170mm (6.69 inches)
Weight Approx		43.0 Kg (94.6 lbs)

Terminal Type (mm)

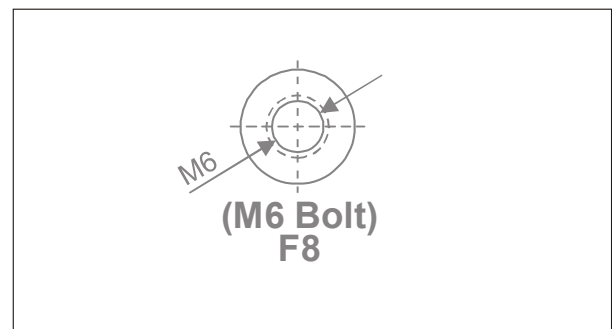

Characteristics

Capacity 25°C(77°F)	20 hour rate(6.50 A)	130 AH
	10 hour rate(12.0 A)	120AH
	5 hour rate(22.1 A)	110.5AH
	1 hour rate(78.0 A)	78.0AH
	1.5 hour discharge to 10.5V	52 A
Internal Resistance	Full charged Battery at 25°C(77°F)	5 m Ω
Capacity affected by Temperature (20hour rate)	40°C(104°F)	102%
	25°C(77°F)	100%
	0°C(32°F)	85%
	-15°C(5°F)	70%
Self-Discharge at 25°C(77°F)	Capacity after 3 month storage	94%
	Capacity after 6 month storage	85%
	Capacity after 12 month storage	64%
Terminal		F8
Charge (constant Voltage)	Cycle	Maximum Charging Current 39.0 A Voltage 14.40-15.00V
	Float	Voltage 13.50-13.80V

Discharge Curves 25 °C(77 °F)

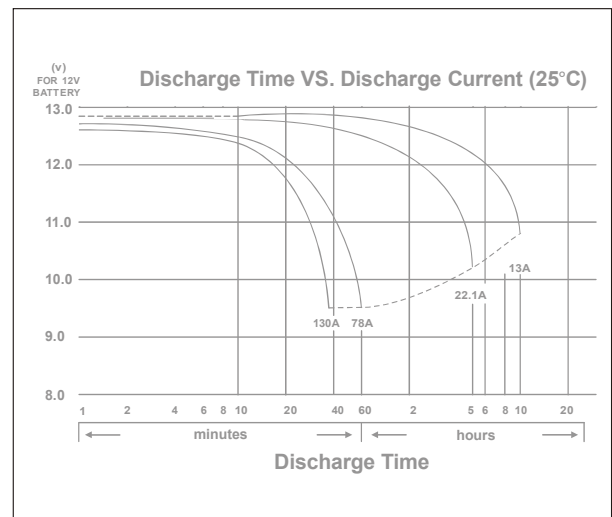

Constant Current(Amp) and Constant Power(Watt) Discharge Table at 25 °C(77 °F)

Time		5 Min	10 Min	15 Min	30 Min	1hr	2Hr	3Hr	4Hr	5Hr	10Hr	20Hr
9.60V	A	459	345	266	154	83.6	49.4	37.9	29.2	24.6	14	7.15
	W	4738	3772	2979	1715	977	567	442	347	298	171	86.8
10.20V	A	419	311	247	143	78.9	46.6	35.7	28	23.9	13.6	6.98
	W	4338	3494	2787	1629	951	544	423	334	289	166	85.2
10.50V	A	394	292	232	136	73.5	44.7	34.4	27.1	23.3	13.3	6.87
	W	3910	3341	2682	1567	928	529	412	325	282	162	83.3
10.80V	A	362	265	211	128	66.4	42.4	32.5	25.8	22.4	13	6.73
	W	3641	3179	2558	1540	896	511	398	314	273	158	81.2
11.10V	A	289	236	182	113	57.8	37.4	29.3	23.7	21.1	12.4	6.54
	W	3281	2943	2402	1468	855	492	384	296	259	152	78.1