

ULTRA MAX®

Sealed Lead Acid Rechargeable Battery Product Specification

SLAUMXNP110-12 (12V110AH)



● Outer dimensions (mm)

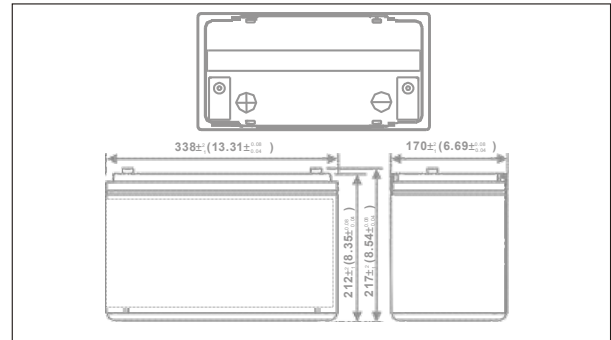

● Specifications

Nominal Voltage		12V
Rated capacity (20 hour rate)		110 Ah
Dimensions	Total Height	217mm (8.54 inches)
	Height	212mm (8.35 inches)
	Length	338 mm (13.1 inches)
	Width	170mm (6.69 inches)
Weight Approx		32.5 Kg (71.5 lbs)

● Terminal Type (mm)

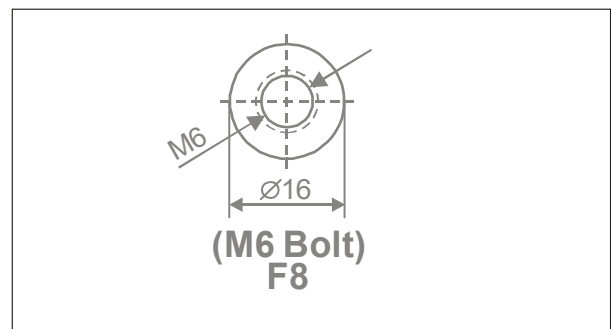

● Characteristics

Capacity 25°C(77°F)	20 hour rate(5.50A)	110 AH
	10 hour rate(10.5A)	105 AH
	5 hour rate(18.7A)	93.5 AH
	1 hour rate(66.0A)	66.0 AH
	1.5 hour discharge to 10.5V	44.0 A
Internal Resistance Full charged Battery at 25°C(77°F)		5 mΩ
Capacity affected by Temperature (20hour rate)	40°C(104°F)	102%
	25°C(77°F)	100%
	0°C(32°F)	85%
	-15°C(5°F)	68%
Self-Discharge at 25°C(77°F)	Capacity after 3 month storage	94%
	Capacity after 6 month storage	85%
	Capacity after 12 month storage	64%
Terminal		F8 (M6 Bolt)
Charge (constant Voltage)	Cycle	Maximum Charging Current 33.0 A Voltage 14.40-15.00V
	Float	Voltage 13.50-13.80V

● Discharge Curves 25 °C(77 °F)

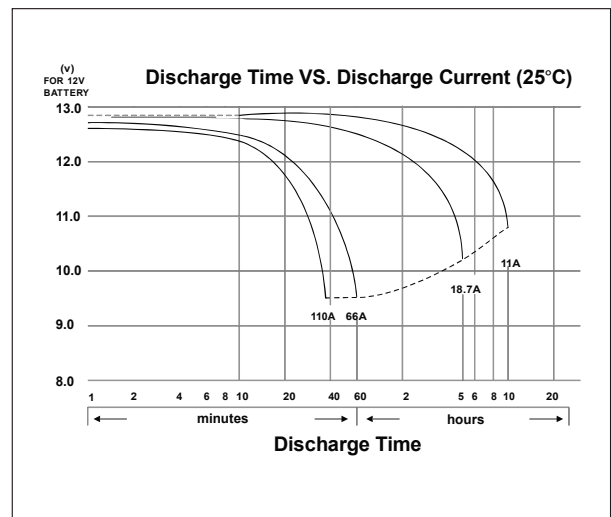

Constant Current(Amp) and Constant Power(Watt) Discharge Table at 25 °C(77 °F)

Time		5 Min	10 Min	15 Min	30 Min	1hr	2Hr	3Hr	4Hr	5Hr	10Hr	20Hr
9.60V	A	387	265	203	114	66.7	38.4	29.1	23.7	20.1	11.8	6.09
	W	4025	2920	2314	1332	800	481	355	292	249	148	77.4
10.20V	A	348	234	184	104	62.4	35.5	27.2	22.5	19.4	11.4	5.91
	W	3634	2650	2124	1243	773	459	339	277	240	144	75.5
10.50V	A	317	217	170	95.1	58.3	32.4	25.7	21.6	18.9	11.2	5.79
	W	3423	2498	2016	1193	756	450	328	265	235	141	74.2
10.80V	A	279	196	151	86.7	52.6	29.2	23.9	20.3	18	11	5.62
	W	3202	2339	1904	1139	738	435	317	253	225	139	72.2
11.10V	A	214	167	124	74.3	44.4	25.1	21.5	18.5	16.8	10.7	5.45
	W	2880	2145	1757	1075	711	414	301	240	211	136	70.3