

# SPECIFICATIONS

## MOTORCYCLE BATTERIES

(MOTUMX2663B, 6N6-3B-1) Conventional

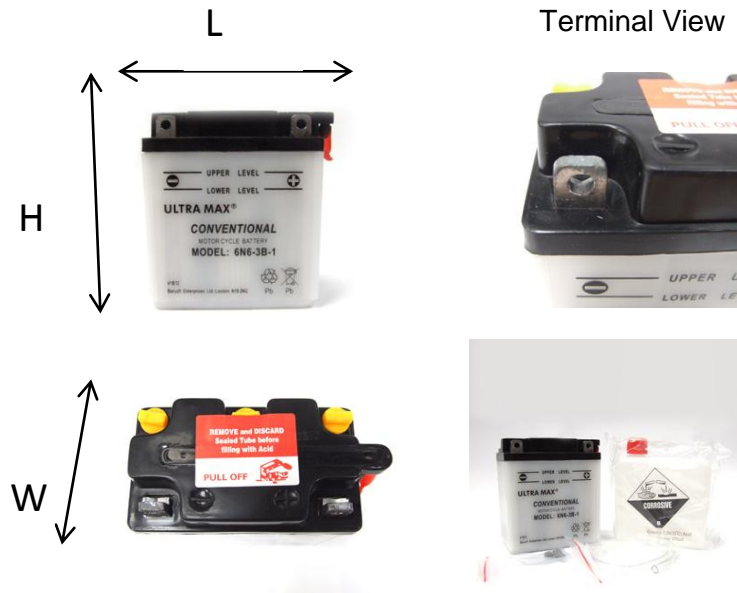

Ultramax Conventional Motorcycle Batteries construction produces extra protection against corrosion, withstand environment vibration and delivers high cranking power.

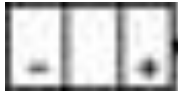
Capacity (Ah/10HR)	6
Dimensions (±2mm)	
L	99
H	57
W	110
Weight w/o Acid (kg)	0.83
Acid Volumn (liter)	0.27
Charge Current (Amp.)	0.60
Assembly Figure	
Terminal Type	5
CCA @-18°C	48